

Clamping examples

Brake drum – 1st operation clamping

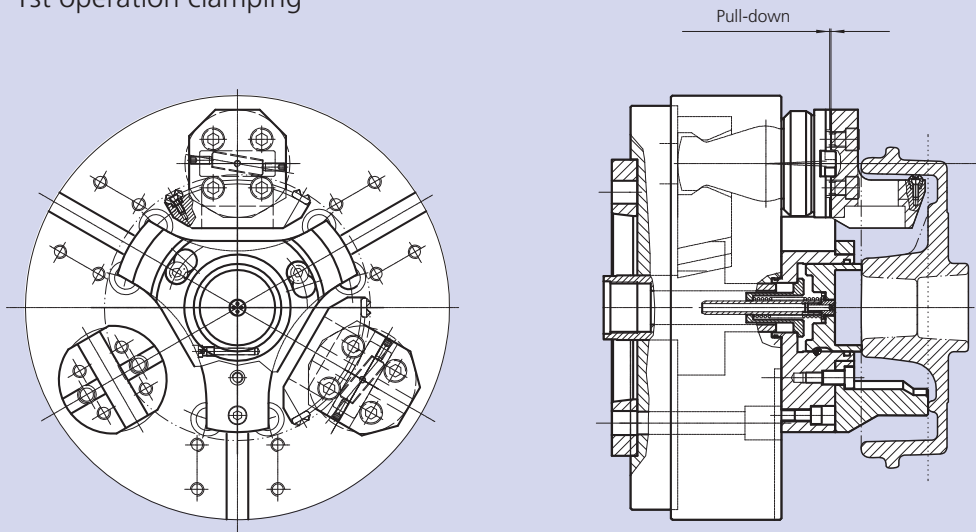

Bearing ring – 2nd operation clamping

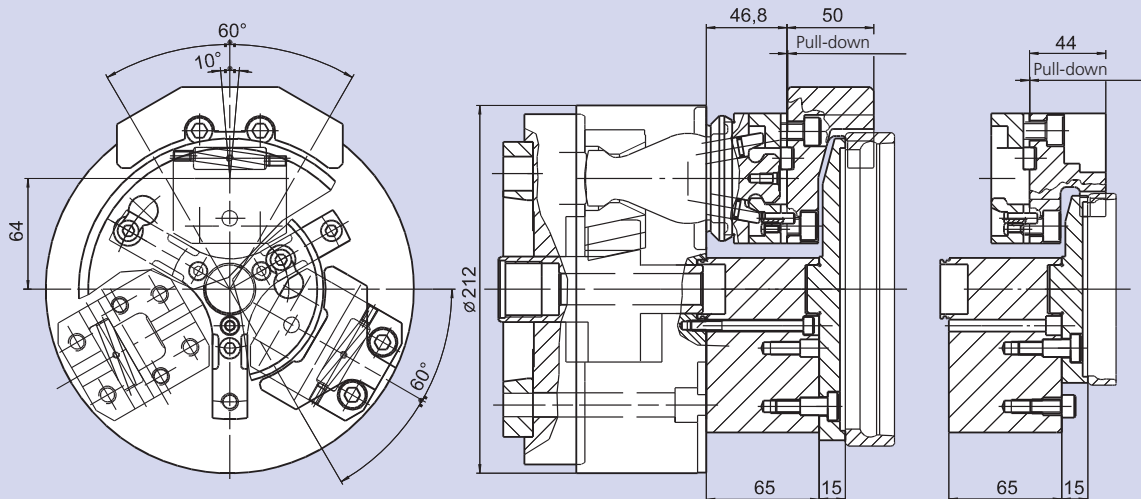

Bearing flange – Complete machining in one set-up

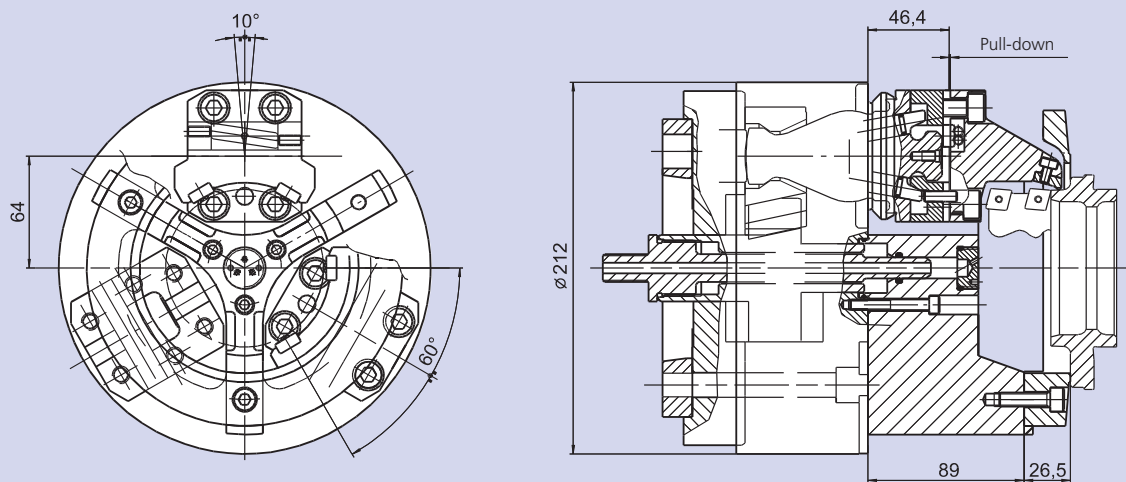



Application/customer benefits

- Power operated, very short centric clamping via clamping sleeves in inner diameter without pull down with retractable stop and position orientation
- For rough cut turning of the frontside and outer diameter, plan sided drilling operations and following finish of the complete outer contour incl. both plan sides through retractable stop
- Power operated clamping with expanding sleeve
- Without pull down
- With retractable stop
- Two-sided plan processing possible

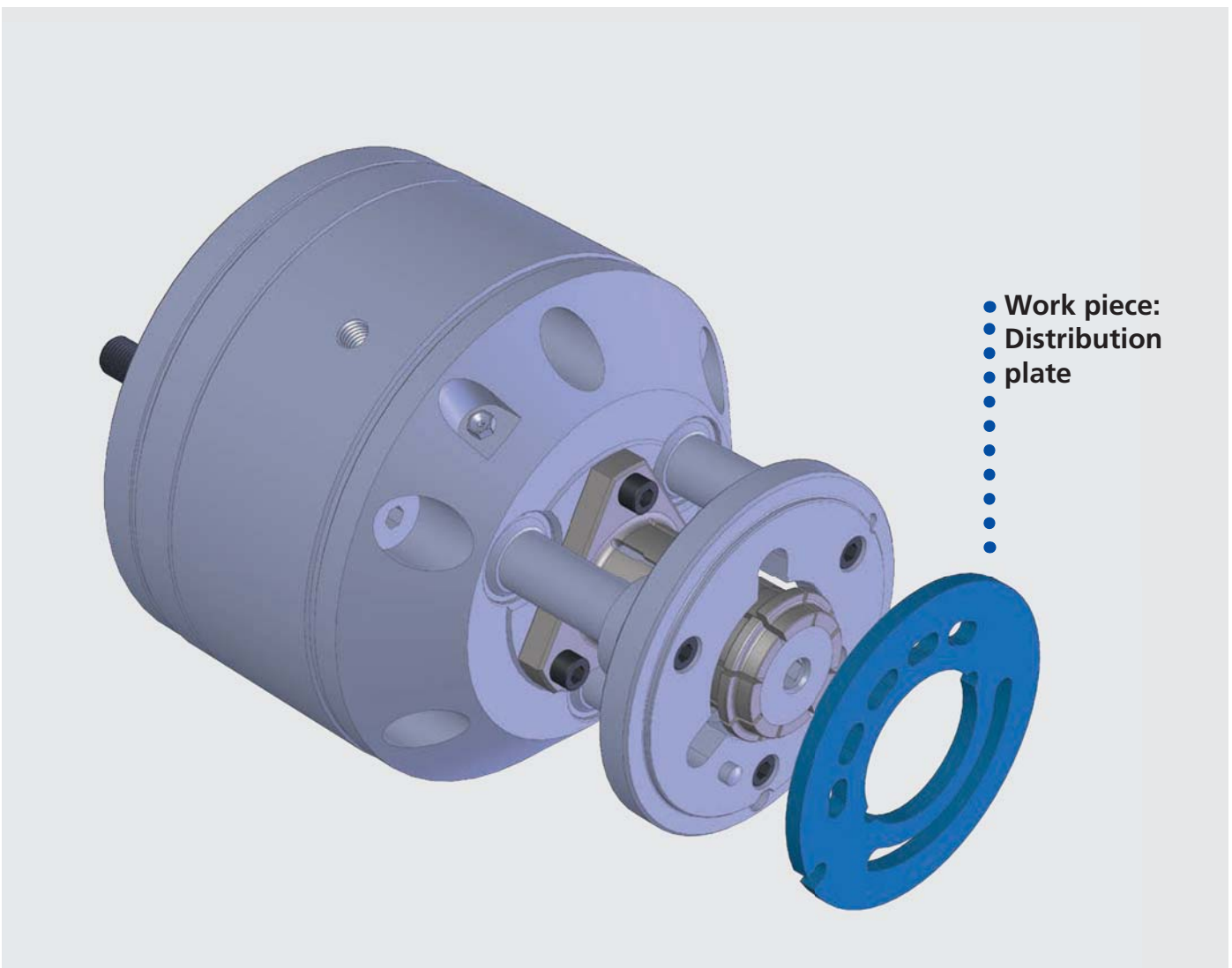

• Work piece:
• Distribution
• plate

Application/customer benefits

- Power operated, centric clamping via clamping sleeve in a spherical 4-Square inner contour with air sensing
- For processing of the outer contour of a Sintermetall work piece with profiled inner contour
- Power operated clamping with profiled sleeve
- Without axial components
- Two-sided plan processing possible

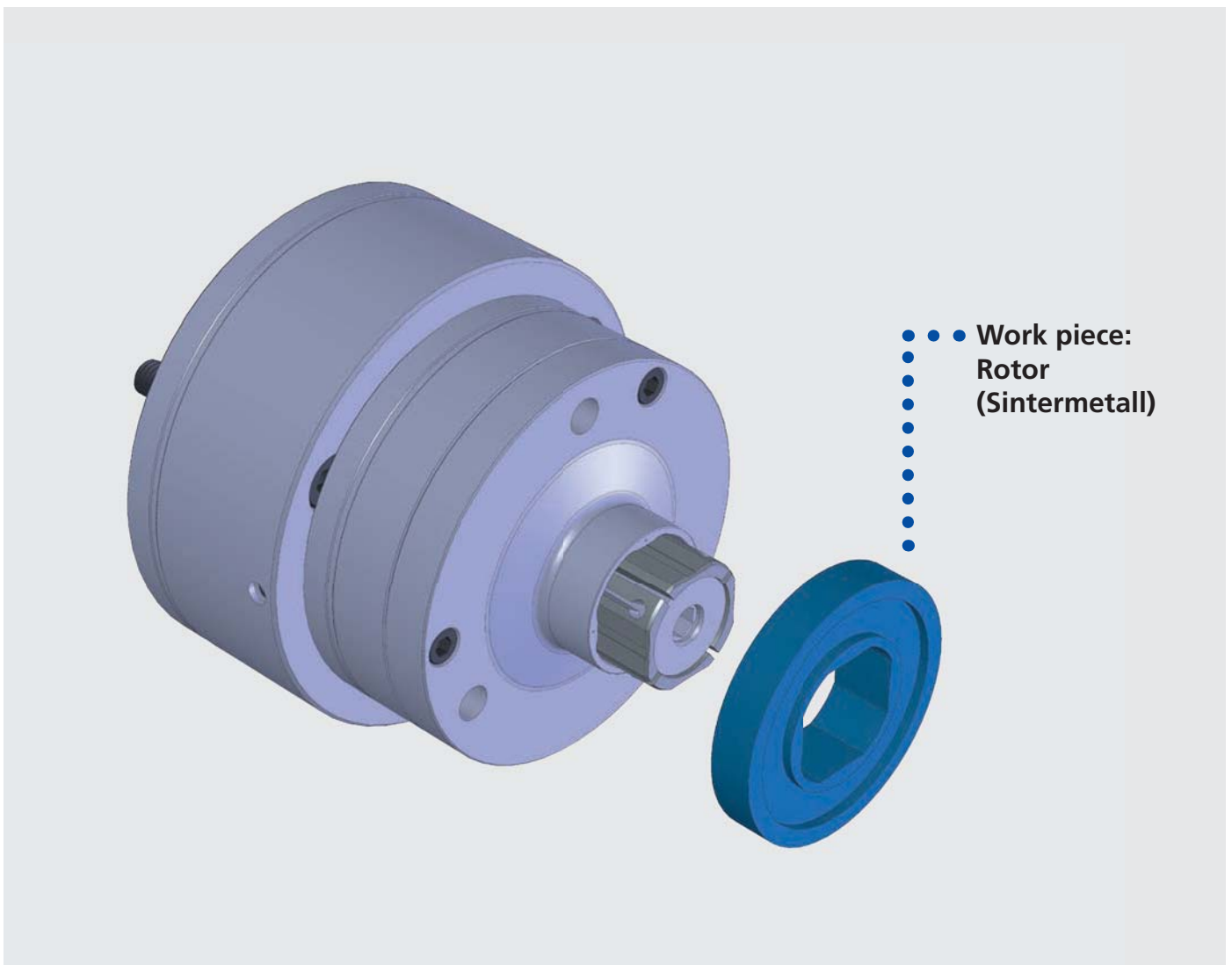

• • • Work piece:
Rotor
(Sintermetall)



Application/customer benefits

- Pneumatic, power operated centering via collet chuck in outer diameter with pull down with additional, power operated pivot fingers with pull down against the stop, with position orientation, air purge and air sensing
- For central turning of non-symmetrical cases
- Position orientation without deforming the work piece
- Pneumatic centering with collet chuck
- Power operated plan clamping with plan collet fingers
- Position orientation
- High repeatability
- Huge machining forces
- Insensitive to contamination

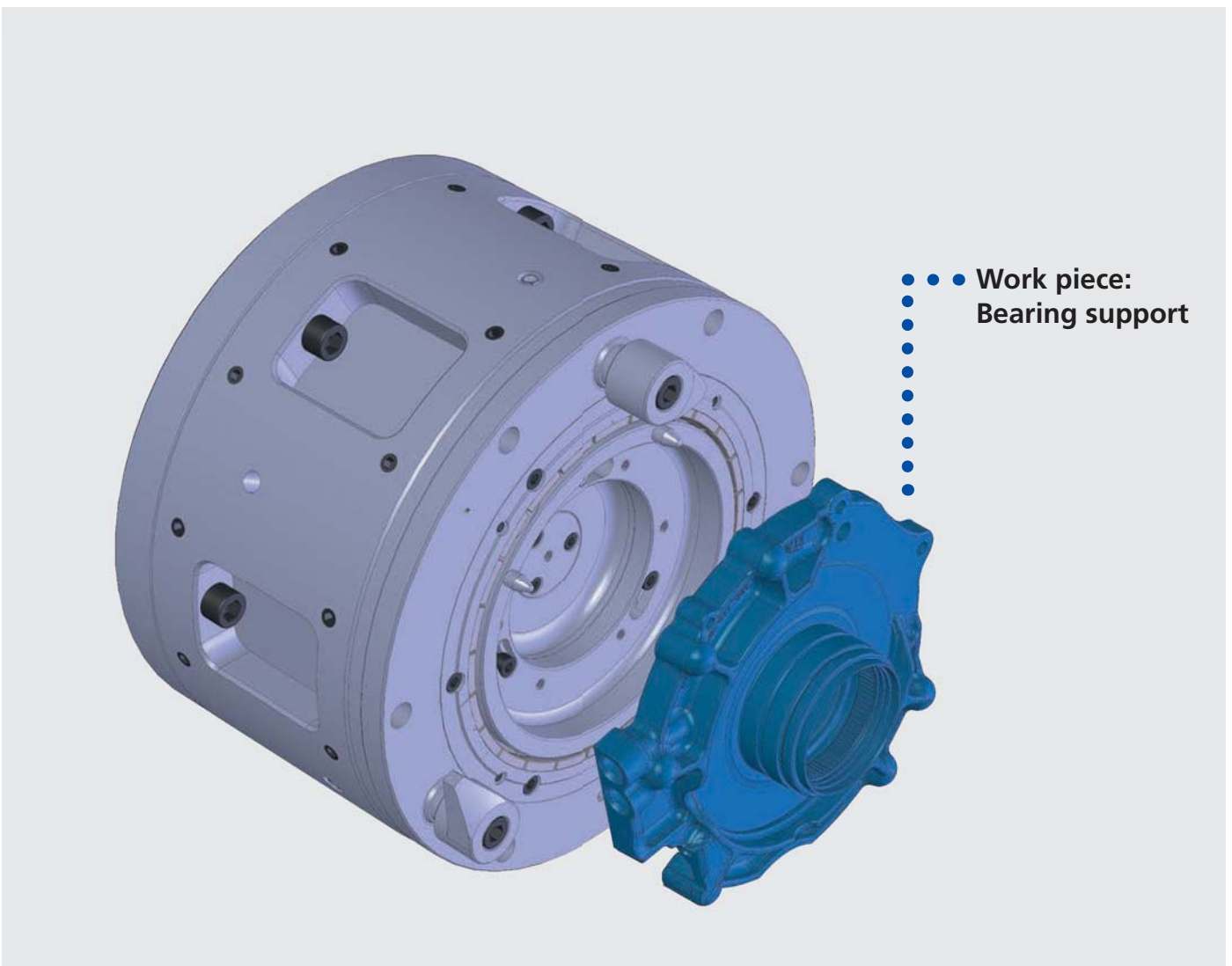

• • • Work piece:
Bearing support